



mawa[®]

mawa – design meets technology

Your designated partner for sophisticated design projects

Your German High-tech Manufacturer



1977 in Berlin



45 employees



mawa design Licht- und Wohnideen GmbH
Ebereschenring 12 – 13, 14554 Seddiner See



www.mawa-design.de



40 years of dedication and expertise

For over 40 years, mawa has been a high-tech manufacturer on an industrial scale, developing and producing "Made in Germany" lighting solutions and luminaires that create emotions.

Founded in 1977 by Martin Wallroth in Berlin, mawa initially developed luminaires and interior design objects. Later, the company focused on technically advanced lighting solutions. From residential and office spaces to shops, museums, monuments and sacred buildings, mawa is the partner of international architects and lighting designers for premium architectural lighting.



Internationally renowned design

Many of mawa's creations have been developed in collaboration with internationally renowned designers, e.g. Günther Ssymmank, Fridtjof F. Schliephacke, Jan Dinnebier or Sauerbruch Hutton ...

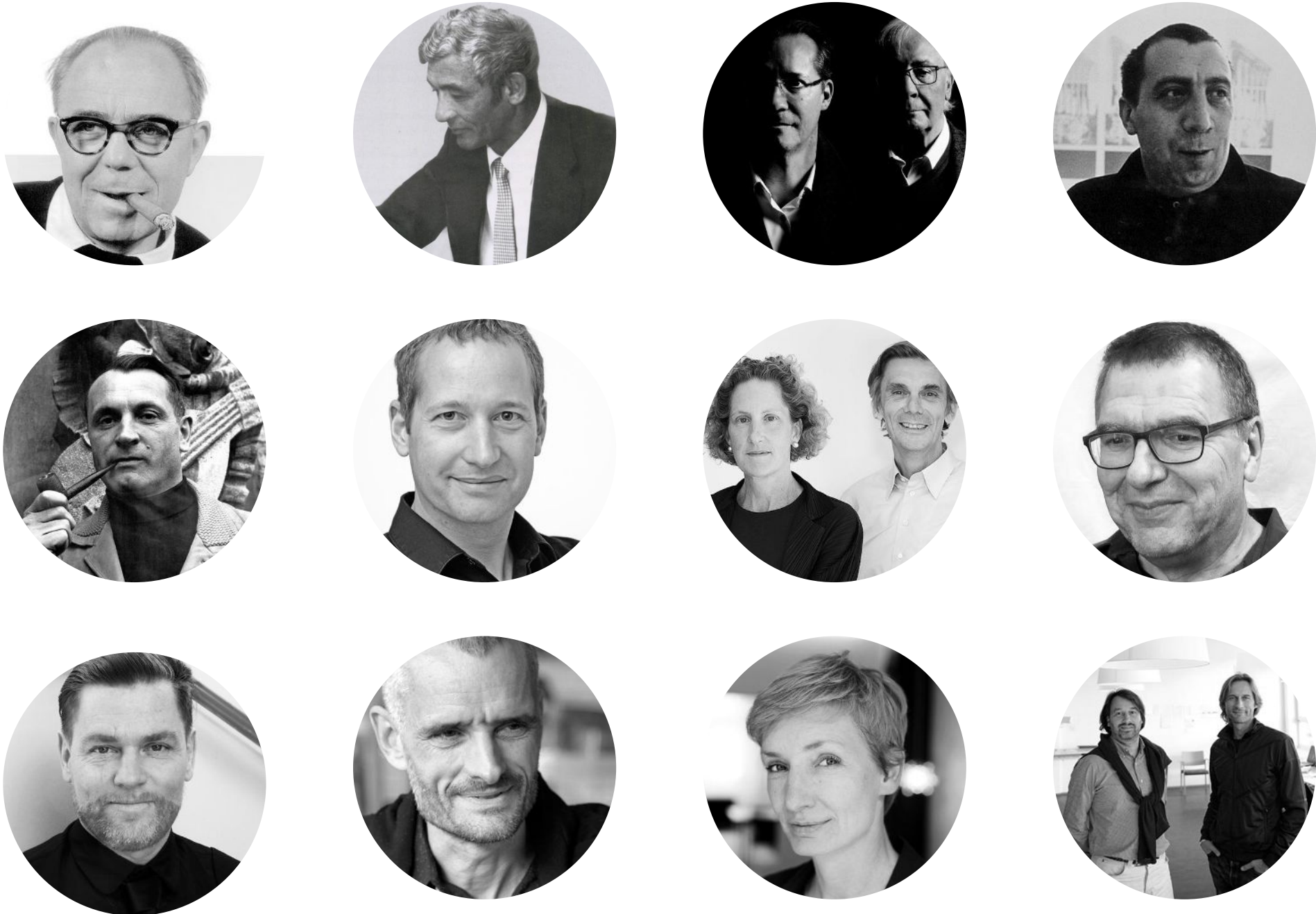

... and are part of leading design collections like the Museum of Modern Art in New York

Commitment to the highest standards

When it comes to the design of our products, top-notch standards are just good enough. Every mawa luminaire is an original developed and produced in Brandenburg/Germany and renounces to any visible screws or cables. Despite their minimalistic design, mawa's lighting solutions dispose of a sculptural character which produces significant effects any time.



mawa luminaires are part of your designs

No matter which project or requirements: mawa's designs can be customized from scratch, giving architects and light planners full control. For example, mawa can do any color. All RAL colours are available on request as well as high-gloss surfaces in chrome, brass, burnished brass or copper. Anodised surfaces can be convincingly imitated with our special "mawa Eloxal" powder coating.



Product Portfolio



wittenberg 4.0



fbl



seventies



decorative lighting



customized luminaires



professional consulting



seventies

seventies – the museum specialist

- + cylindrical shape
- + certified museum quality
- + flicker-free
- + numerous accessories
- + LED modules, reflectors and performance category modularly configurable for special lighting requirements
- + Ra > 95 (typ. 97)
- + new light qualities on request: natural, brilliant, horticulture
- + highest performance category
- + for especially high rooms up to approx. 9.00m
- + suitable for tv productions
- + Tunable White versions for product variants



seventies – the museum specialist

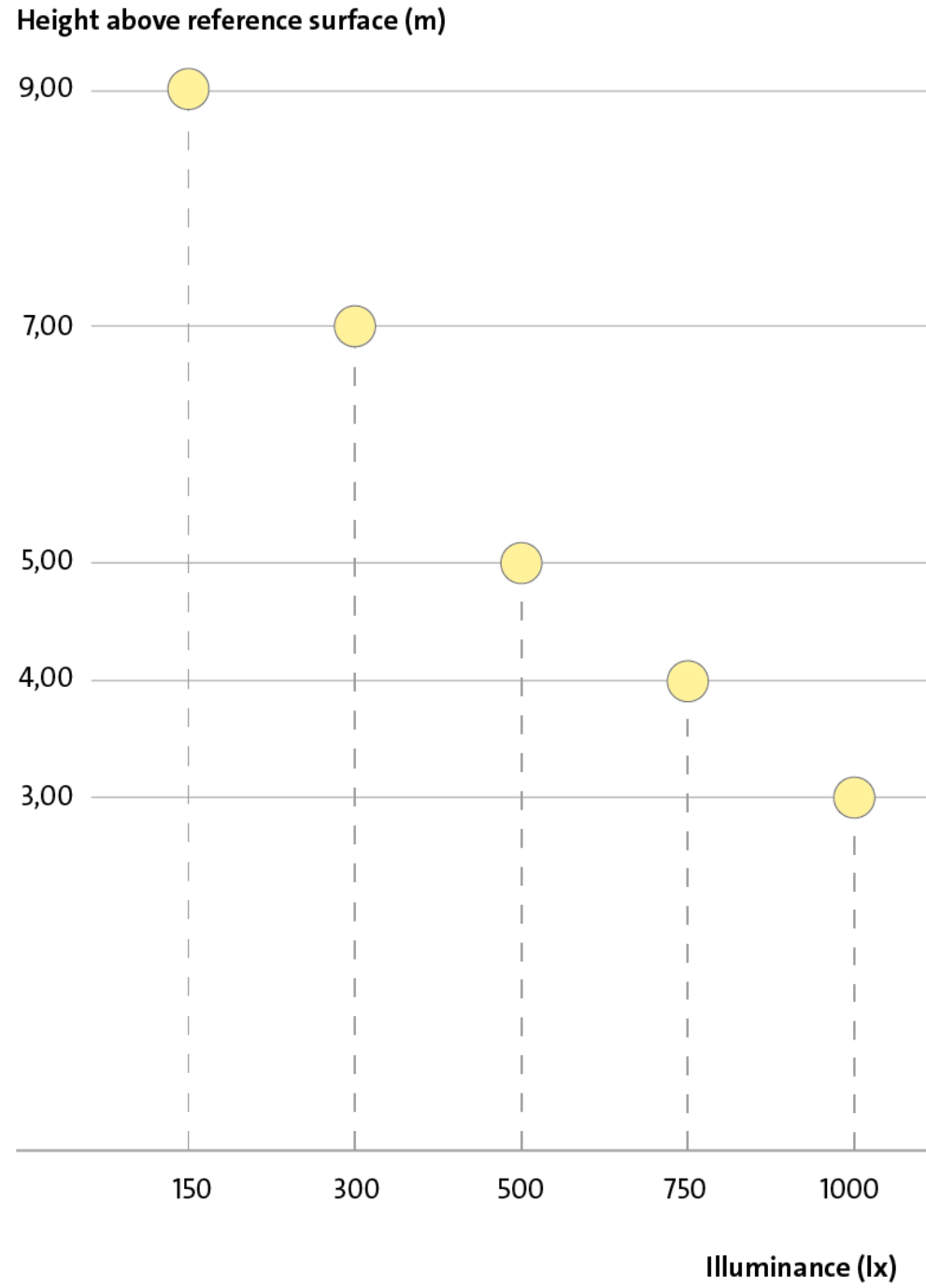

Mounting up to max. 9.00 m height above reference surface 150– 1000lx illuminance

IMPORTANT: does not contain any information on seventies with tunable white



Focusing accessories for seventies

Stepless beam angle

11° – 48° (LES Ø 10 mm) resp.

15° – 50° (LES Ø 14,5 mm)

In the black oxide ceramic version, this leads to a particularly high light absorption coefficient as well as a low gloss level and is therefore ideal for reducing stray light and reflections.

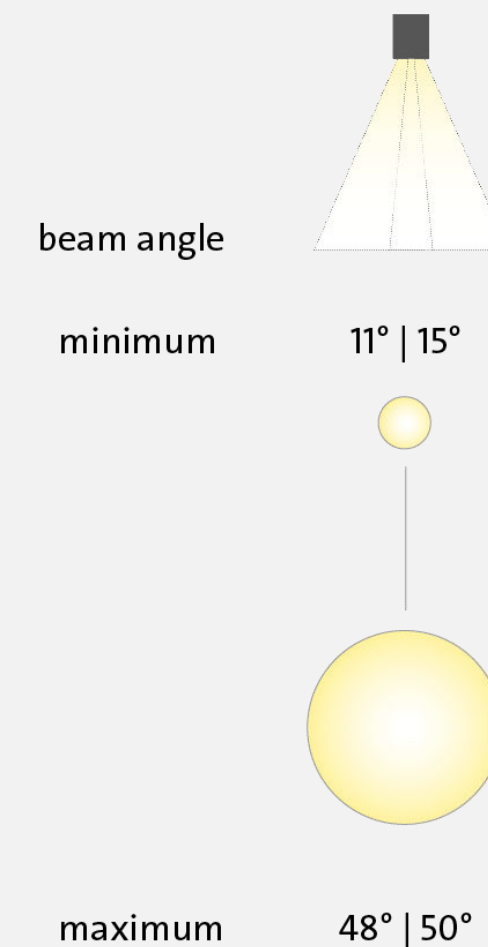

seventies contour spotlight

- 355° rotatable and 90° tiltable
- integrated transformer technology
- tool-free adjustment
- available versions: track light + surface mounted



Components & accessories for seventies

Accessory holder
(black matt and white matt oxide ceramic coating, silver anodized)

black **se-hr-s**
silver **se-hr-si**
white **se-hr-w**

Reflectors for seP-11-d1 (LES 10)

spot 1 (11°) **se-re-sp1**
spot 2 (13°) **se-re-sp2**
medium 1 (17°) **se-re-md1**
flood 1 (26°) **se-re-fl1**
flood 2 (37°) **se-re-fl2**
flood 3 (47°) **se-re-fl3**

Reflectors for seP-11-d2 (LES 14,5)

spot 1 (16°) **se-re-sp1**
spot 2 (16°) **se-re-sp2**
medium 1 (20°) **se-re-md1**
flood 1 (30°) **se-re-fl1**
flood 2 (40°) **se-re-fl2**
flood 3 (52°) **se-re-fl3**

Clear borosilicate glass se-g-c

Sculpture lens for elliptical light distribution se-g-sk

fine prismatic lens se-fp

Black honeycomb grid se-wa-s

Suction lifter sh1

Shutter incl. 70's black retainer ring
(inner part oxide ceramic finish black)

30 mm symmetrical white (powder-coated) **se-sh-9016**

30 mm symmetrical black (powder-coated) **se-sh-9005**

4 anti-glare flaps
(oxide ceramic finish) **se-bl-4**

IMPORTANT: retainer ring and accessory holder holder included in anti-glare flaps

LSD beam diverging attachment to diverge the beam angle:

	spot 1	spot 2	medium 1	flood 1	flood 2	flood 3
Beam angle with LES 10 mm	11°	13°	17°	26°	37°	47°
+ LSD 30° se-lsd-30°	32°	33°	34°	40°	48°	56°
+ wallwasher lens LSD 60° se-lsd-60°	61°	61°	62°	65°	70°	70°
Beam angle with LES 14,5 mm	16°	16°	20°	30°	40°	52°
+ LSD 30° se-lsd-30°	34°	34°	36°	42°	50°	60°
+ wallwasher lens LSD 60° se-lsd-60°	62°	62°	63°	67°	72°	79°

retainer ring black se-fr-s

Shutter incl. 70's black retainer ring
(inner part oxide ceramic finish black)

90 mm asymmetrical white (powder-coated) **se-sh-as-9016**

90 mm asymmetrical black (powder-coated) **se-sh-as-9005**

accessory holder anti-glare flaps
(oxide ceramic finish)
black **se-hr-bl-s**
white **se-hr-bl-w**



wittenberg 4.0

wittenberg 4.0 – the multi-talent

- + compact cylindrical design
- + Ra > 95 (typ. 98)
- + optimum model and design variety
- + numerous accessories
- + also flicker-free
- + individual production on request
- + driver-integrated adapters possible
- + advanced performance category
- + for high rooms up to approx. 5.00 m



wittenberg 4.0 technical information

Beam angle

12° / 24° / 38°

Wattage LED

12,7 W / 12 W (dim2warm)

Light colours | Luminous flux LED

2700 K / Ra > 95 (typ. 98) | 930 lm

3000 K / Ra > 95 (typ. 98) | 980 lm

4000 K / Ra > 95 (typ. 98) | 1100 lm

1800 – 3000 K / Ra 95 (typ. 97) dim2warm | 1045 lm

further light colours on request

Dimming

Rotary potentiometer on the housing

DALI

Leading edge / trailing edge phase

Bluetooth

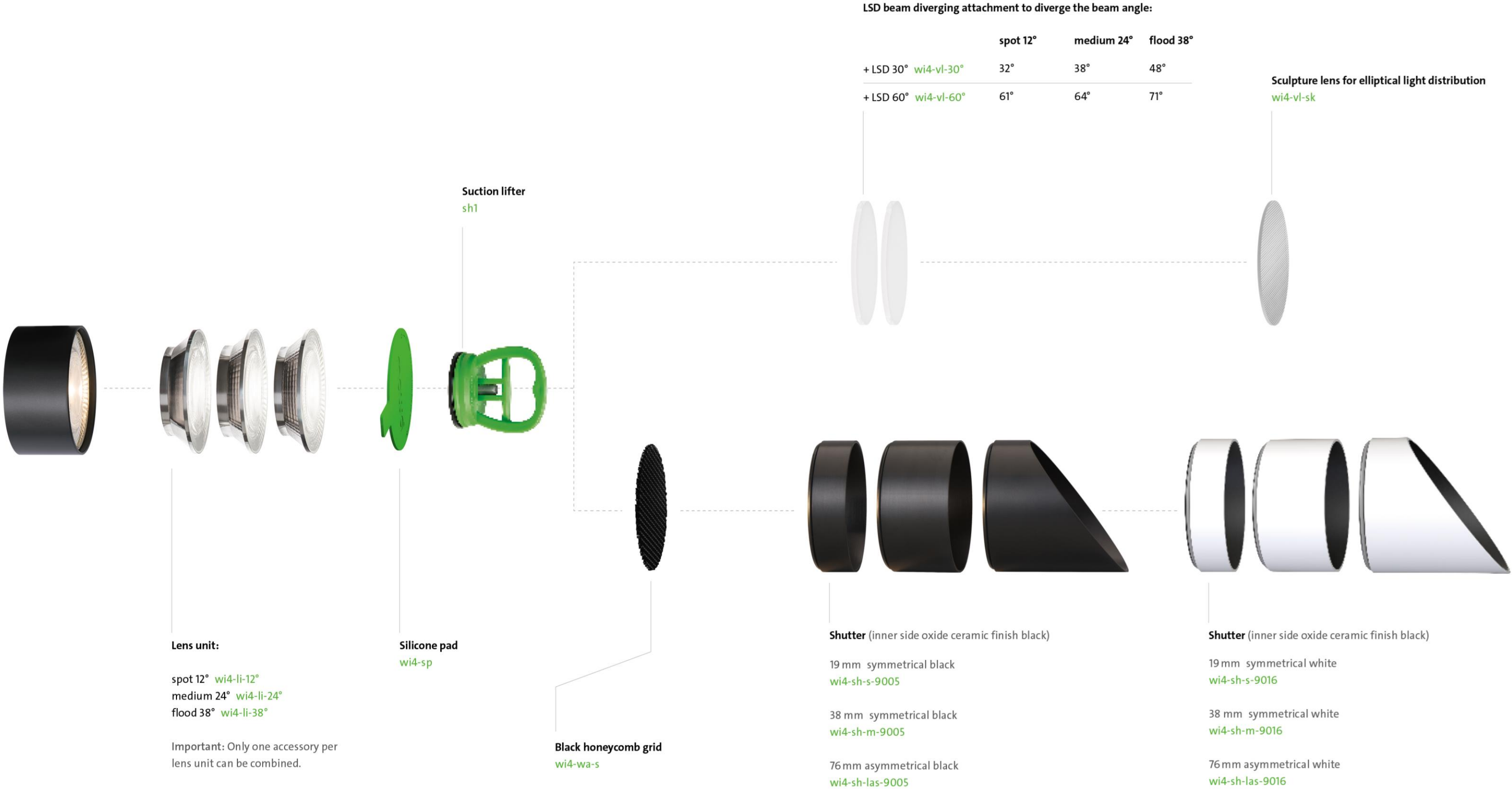

Photo: Adrian Schulz, SSV Architekten

wittenberg 4.0 examples



Components & accessories for wittenberg 4.0





fbl

fbI – the Aesthete

- + compact design
- + Ra > 95 (typ. 97)
- + pioneering hard-edge design
- + high-precision edges thanks to patented mawa folding technology
- + flush-mounted with mawa recessed profile
- + flicker-free
- + driver-integrated adapters possible
- + mid-range performance category
- + for manageable room heights up to approx. 4.00 m

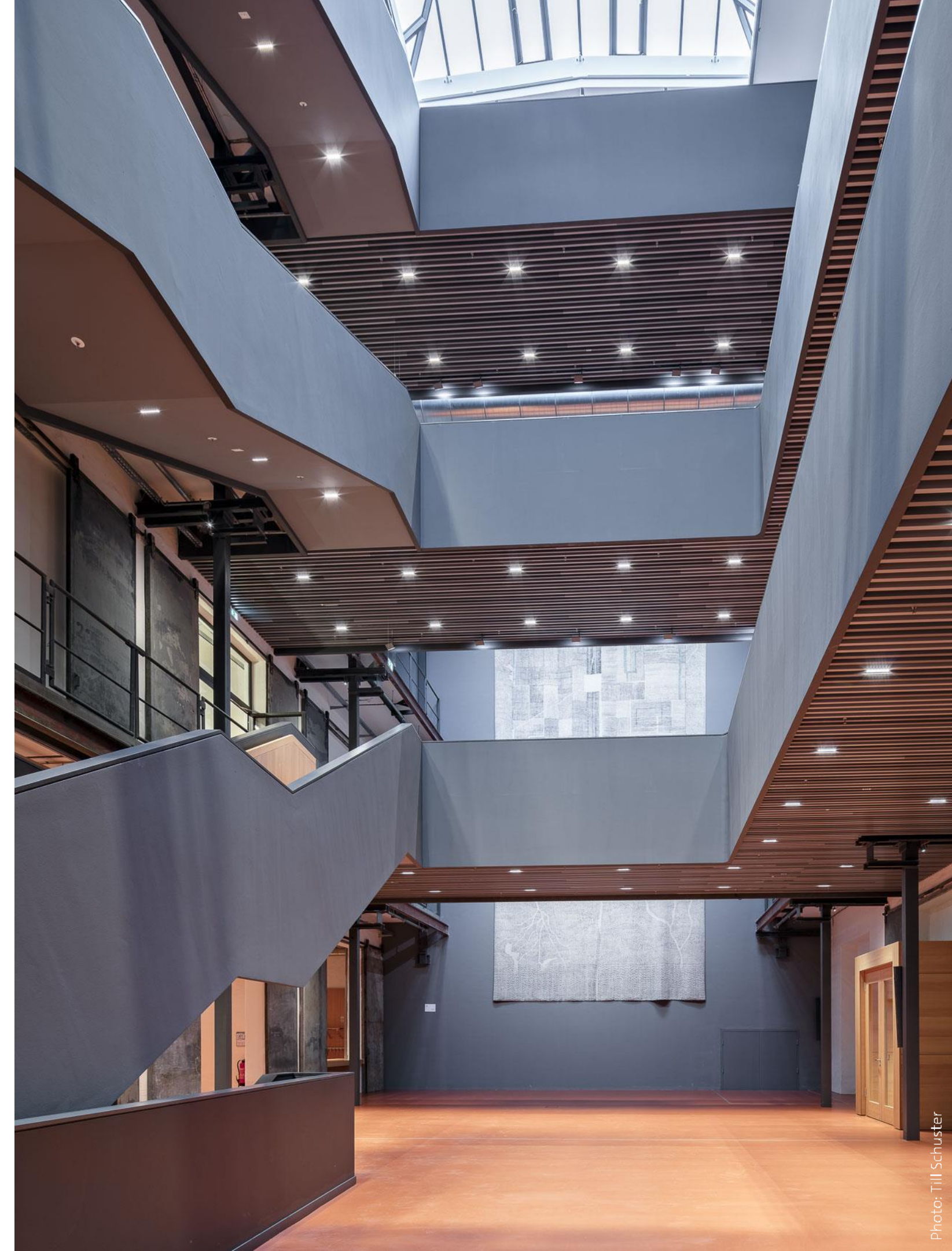

fbl – the Aesthete

Beam angle

12° / 30° / 45°

Wattage LED

15 W

Luminous flux LED

1200 – 1400 lm

Light colours

2700 K / Ra > 95 (typ. 97)

3000 K / Ra > 95 (typ. 97)

4000 K / Ra > 95 (typ. 97)

2700 K / Ra > 90 on request

3000 K / Ra > 90 on request

4000 K / Ra > 90 on request

further light colours on request

Dimming

DALI

Leading edge / trailing edge phase

Bluetooth



Components & accessories for fbl



Lens unit:

- spot 12° fbl-re-12°
- medium 30° fbl-re-30°
- flood 45° fbl-re-45°



LSD beam diverging attachment to diverge the beam angle:

	spot 12°	medium 30°	flood 45°
+ LSD 20° fbl-av-20	23°	36°	49°
+ LSD 30° fbl-av-30	32°	42°	54°
+ LSD 40° fbl-av-40	42°	50°	60°
+ LSD 60° fbl-av-60	61°	67°	75°

Black, anodised anti-glare attachment for ideal anti-glare function
fbl-sh



Acryl cover

Office & commercial building Upper West Berlin

CNC-milled luminaires: freeform channel in the foyer

The project-specific, specially constructed custom lights for Upper West came from the pen of well-known, Berlin based lighting designer, Edgar Schlaefle.

In addition to satin-finished cylindrical rods, manufactured products include diverse general lighting constructed of conical rod segments, backlit floor level indicators, and in the foyer, a diffuse-emitting freeform channel, flush-mounted in the ceiling.

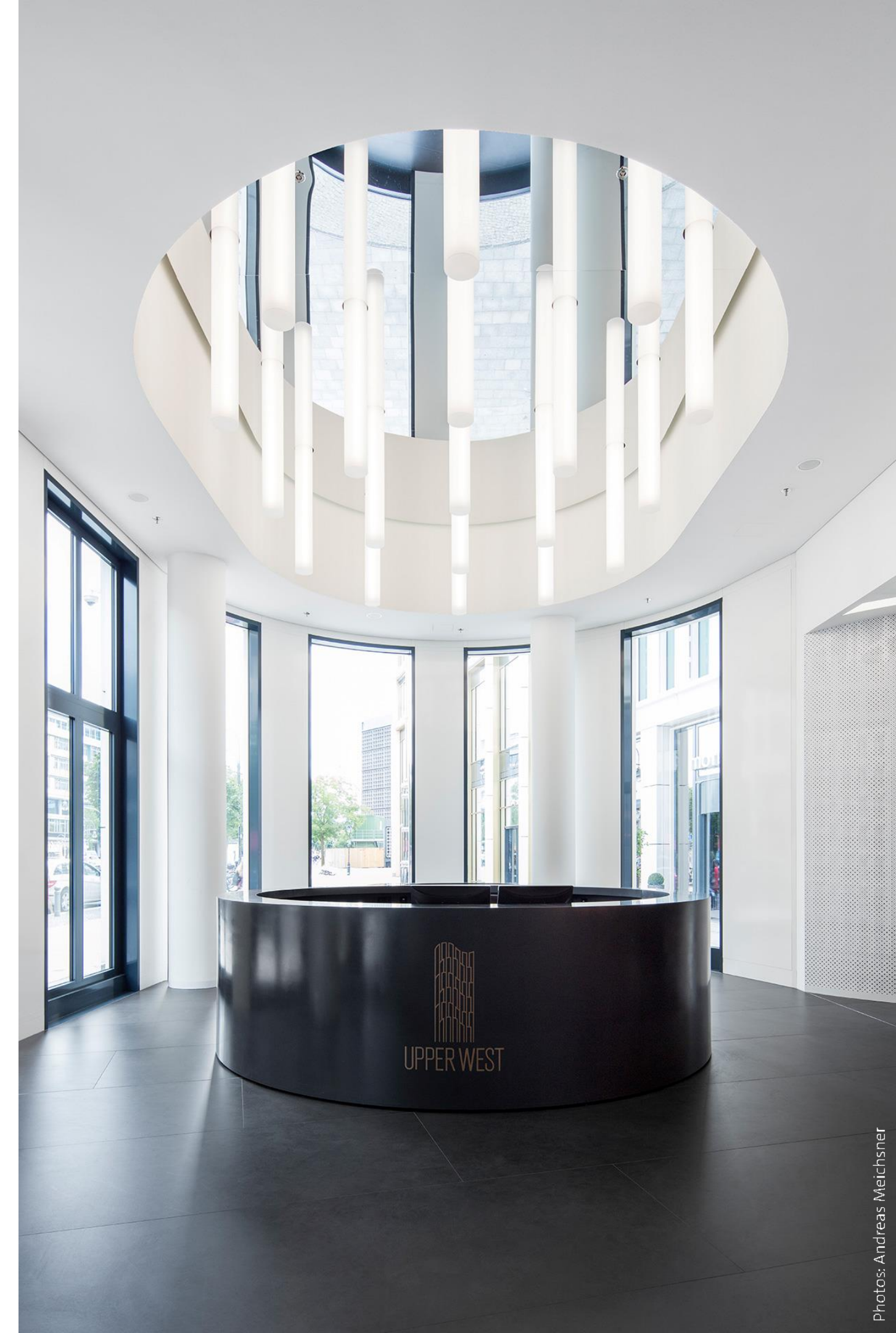

Office & commercial building Upper West Berlin

Scope of services

8 × wittenberg 4.0 recessed spotlight

312 × rod ceiling lamp 250 mm

12 × rod ceiling lamp 1200 mm

19 × rod ceiling lamp 1500 mm

24 × rod ceiling lamp, office levels

5 × backlit floor level indicator copper

56 × backlit floor level indicator black

8 × ceiling plate lamp copper

60 × cylindrical rod lamp 4

2 × cylindrical rod lamp 7

1 × light channel

1 × backlit wall covering

46 × fbl contact track spotlight fbl-11-4

17 W, 3000 K, 1400 lm, matt white (RAL 9016)

3 × fbl surface-mounted spotlight fbl-21-4

17 W, 3000 K, 1400 lm, matt white (RAL 9016)

22 × seventies surface-mounted spotlight se-21-4

26 W, 3000 K, 2600 lm, matt white (RAL 9016)

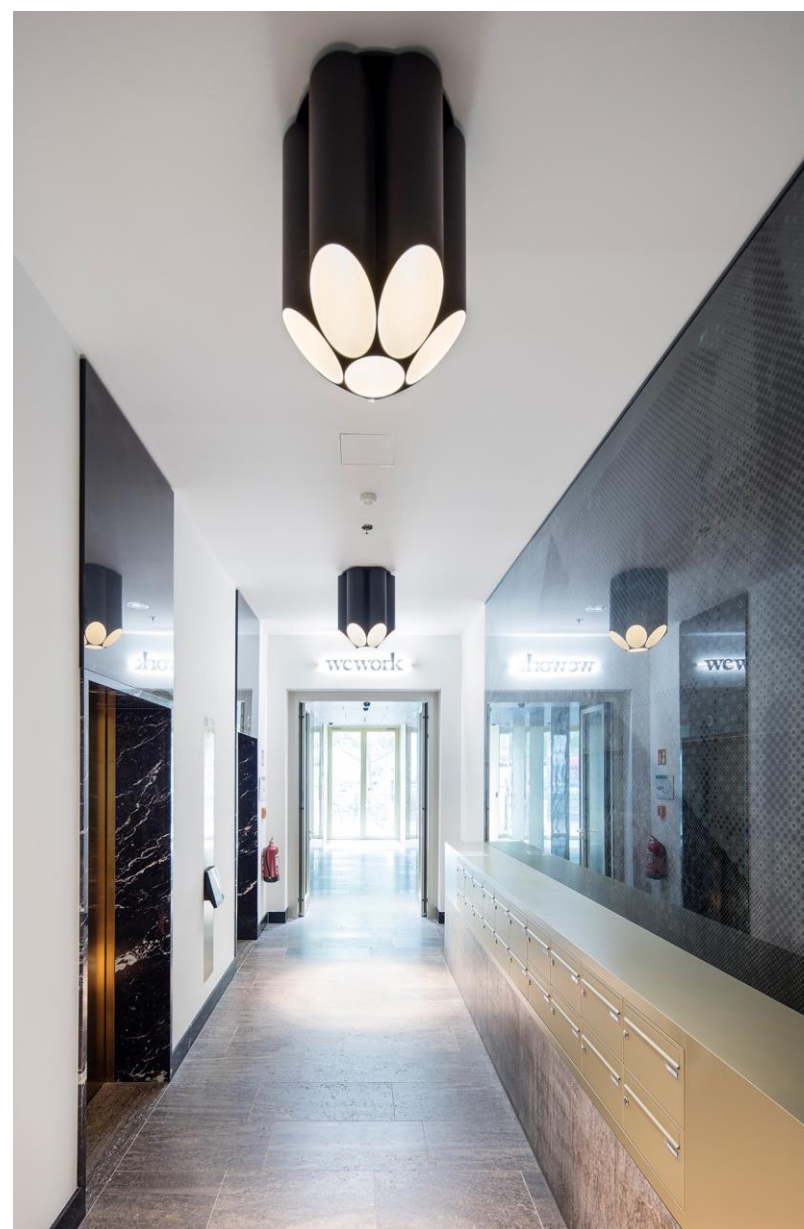

VW auto city Wolfsburg

The world's largest 360° display with 180,000 flip dots

In auto city, the inclined visitor doesn't find out when and where to receive their new car from an LED panel, instead nearly 180,000 tiny flip dots, every single one individually driven by electromagnetic impulses, show the way.

The ring, constructed of 44 single segments, is the world's largest 360° display board, and thanks to modular components, easily disassembled and transportable in flight cases. It's installed at a height of 3.60 m and with a diameter of nearly 9 metres.



mawa is part of the **PROLED GROUP**

PROLED GROUP is your one-stop-shop for professional, innovative LED lighting. Say no more - we have you covered. From high-tech manufacturing made in Germany to linear lighting and architectural plug & play solutions.



Contact

mawa®



Jannis Franzen
Export Manager

j.franzen@mawa-design.de
+49 173 643 59 60

mawa design
Licht- und Wohnideen GmbH
Ebereschenring 12–13
14554 Seddiner See
GERMANY

tel +49 33205 22 88 22

info@mawa-design.de
www.mawa-design.de